

# Attachment D

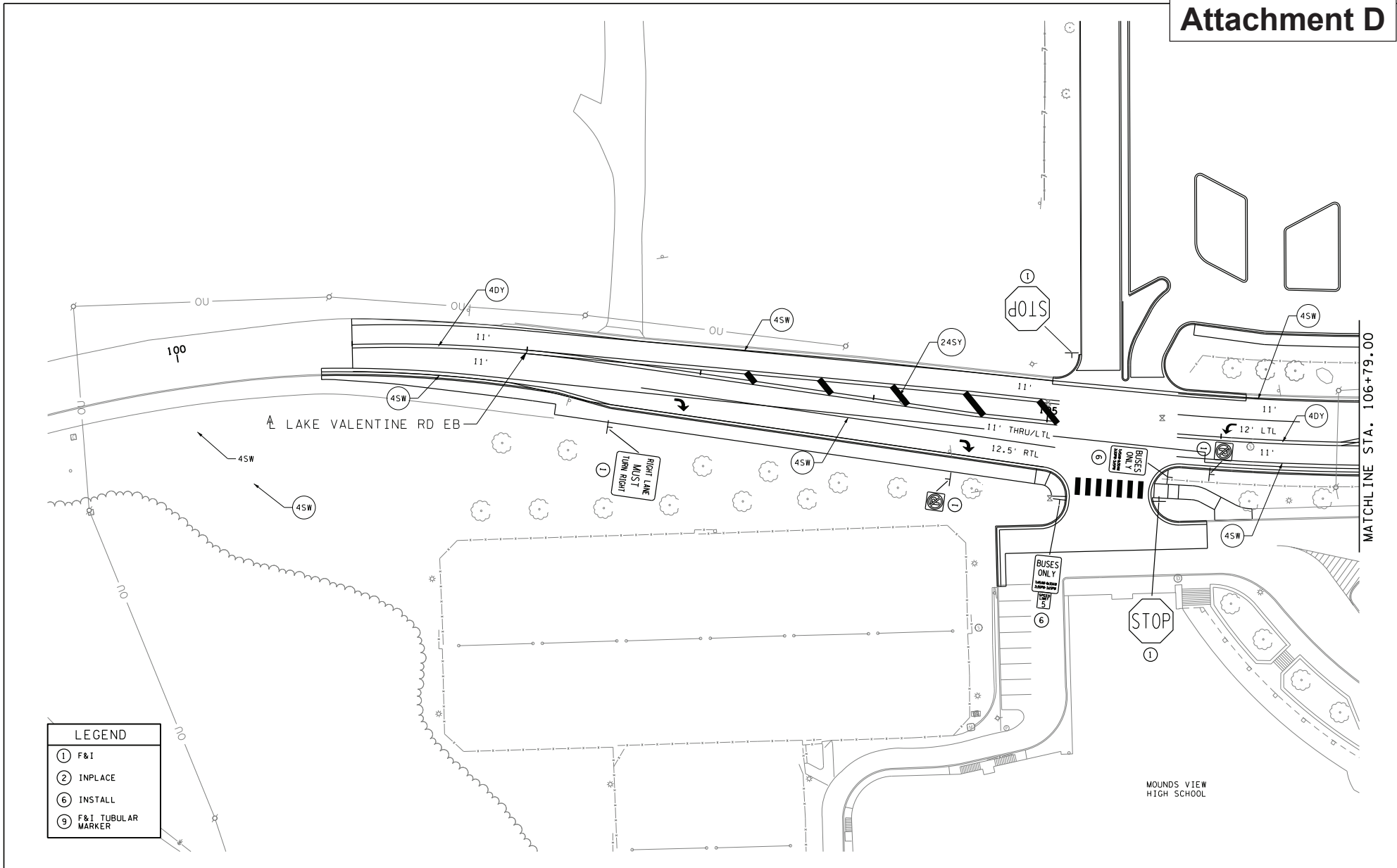

LEGEND	
①	F&I
②	INPLACE
⑥	INSTALL
⑨	F&I TUBULAR MARKER



32224 NICOLLET AVENUE  
 BURNSVILLE, MINNESOTA, 55337  
 Phone: (952) 890-0509  
 Email: burnsville@bolton-menk.com  
 www.bolton-menk.com

REV.	BY	DATE

I HEREBY CERTIFY THAT THIS PLAN, SPECIFICATION, OR REPORT WAS PREPARED BY ME OR UNDER MY DIRECT SUPERVISION AND THAT I AM A DULY LICENSED PROFESSIONAL ENGINEER UNDER THE LAWS OF THE STATE OF MINNESOTA.

**ENGINEER SIGNATURE 1**

MICHAEL S. LARSON  
 LIC. NO. 58846      DATE XX-XX-XXXX

DESIGNED	CML
DRAWN	CML
CHECKED	MSL

MVHS ISD 621 / CITY OF ARDEN HILLS  
 LAKE VALENTINE RD PROJECT  
**PROPOSED SIGNING & STRIPING PLAN**

SHEET  
 59  
 OF  
 77

ChrisLloyd  
 11/13/2021  
 pdf-B and M,gitcfcg  
 6:16:52 PM  
 bmi,tbi

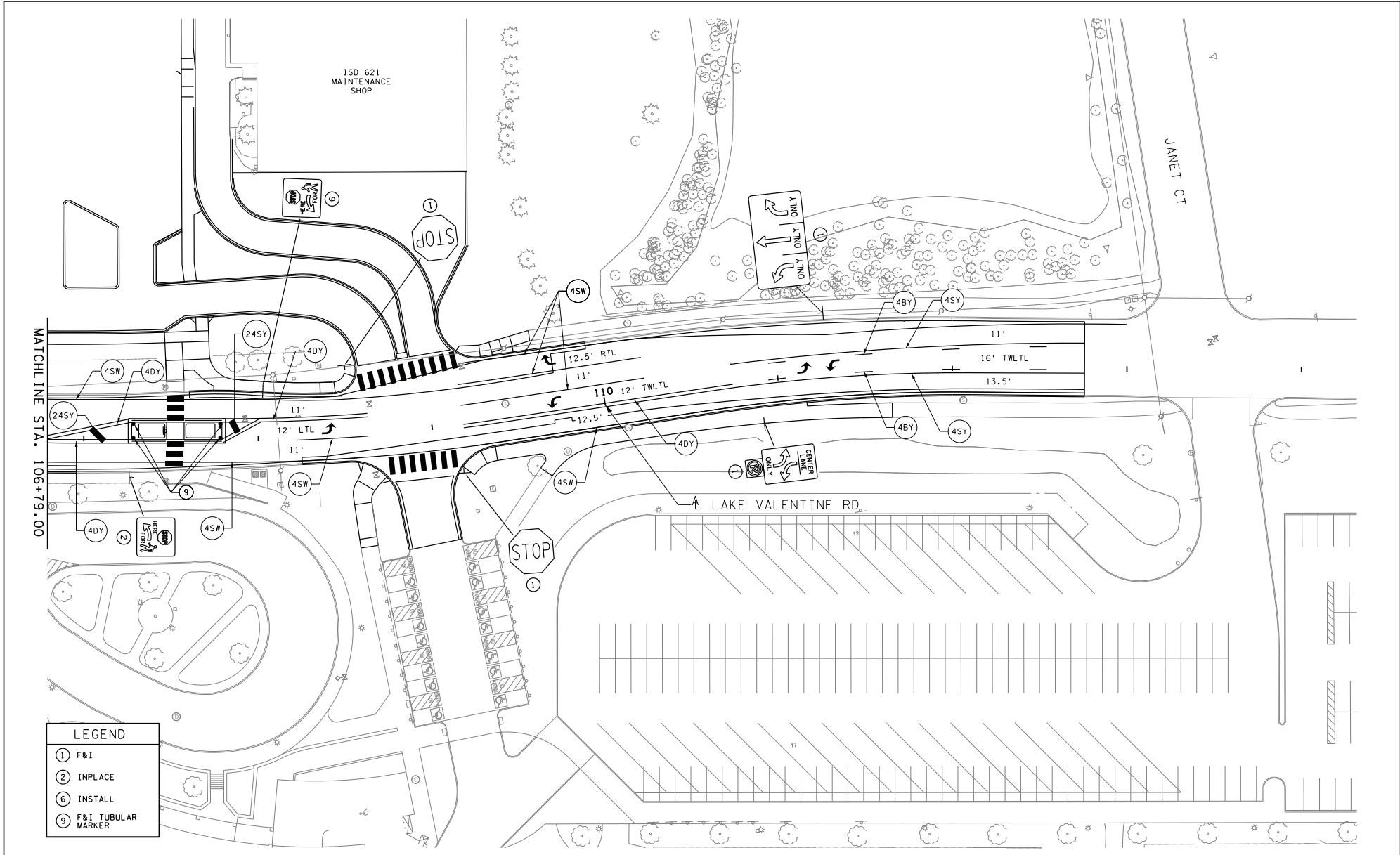

LEGEND	
①	F&I
②	INPLACE
⑥	INSTALL
⑨	F&I TUBULAR MARKER



32224 NICOLLET AVENUE  
 BURNSVILLE, MINNESOTA, 55337  
 Phone: (952) 890-0509  
 Email: BurnsVille@bolton-menk.com  
 www.bolton-menk.com

REV.	BY	DATE

I HEREBY CERTIFY THAT THIS PLAN, SPECIFICATION, OR REPORT WAS PREPARED BY ME OR UNDER MY DIRECT SUPERVISION AND THAT I AM A DULY LICENSED PROFESSIONAL ENGINEER UNDER THE LAWS OF THE STATE OF MINNESOTA.

**ENGINEER SIGNATURE 1**

MICHAEL S. LARSON  
 LIC. NO. 58847 DATE XX-XX-XXXX

DESIGNED	CML
DRAWN	CML
CHECKED	MSL

MVHS ISD 621 / CITY OF ARDEN HILLS  
 LAKE VALENTINE RD PROJECT  
**PROPOSED SIGNING & STRIPING PLAN**

SHEET  
 60  
 OF  
 77

bml:tbl

pdf-B and M,plc:cfp  
 6/16/23 PM

ChrisLloyd  
 11/17/2021

H:\WORLD\_PR\OV1125296\CAD\MS\plans\SignStrip\Proposed Signing & Striping\cd125296\_stp002.dgn